

**makfa**

# KABİN KİLİDİ C05-PC



## KULLANIM KILAVUZU

To the valued customer;

Thank you for entrusting us with your valuable belongings.

The product you purchased was manufactured by MAKFA Electronics Ltd. in Turkey.

## FEATURES

- Stainless Steel Surface.
- Operates with 4 Alkaline batteries.
- Option to connect an adapter.
- Capability to set a password between 1 and 10 digits.
- Ability to define 10 user cards.
- Easy setup of user password.
- Ability to use Master card and Master password.
- Easy installation and setup.
- Provides a warning when the cabinet door is forced.

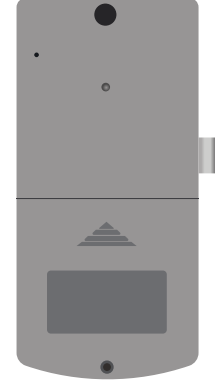

## TECHNICAL SPECIFICATIONS

Product Name	:	Makfa Elektronik Cabin Lock
Product Code	:	C05-PC RFID
Power Supply	:	4 Adet Alkalın pil
Static Current	:	$\leq 5\mu A$
Dinamic Current	:	$\leq 250mA$
Working Temp	:	$-25^{\circ}C \sim +65^{\circ}C$
Nem Oranı	:	%5~%95RH
Working Humidity	:	Stainless Steel Surface
Usage Period	:	More than 100.000 times unlocking

## ASSEMBLY

- "After opening the case cover, carefully insert the batteries into the battery compartment while paying attention to the poles.  
Your case lock will become active at this stage.



- PLEASE OPEN THE COVER MANUALLY AND DO NOT BREAK THE LOCK !!!

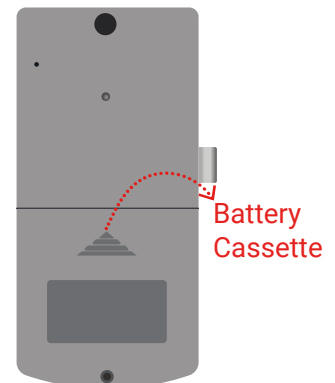

## RESETTING THE CABINET LOCK TO FACTORY SETTINGS

- Press the reset button on the back of the cabinet lock 4 times. Each time you press the reset button, you should hear a "beep" sound. After hearing 4 short "beep" sounds, the blue LED light will flash rapidly. After 5 seconds, a long "beep" sound and the sound of the motor running will occur. All user data will be erased. The cabinet lock will return to factory settings and enter the general usage mode. The master password is "00000000". The user password is "1111".

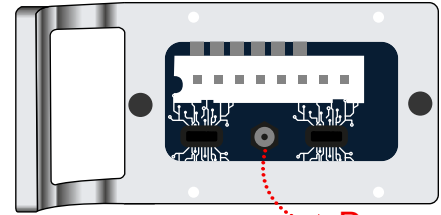

→ Press 4 times.

## CREATING MASTER CARD

- After performing the reset process, scan the card you want to make the master card on the cabinet lock twice. After hearing 2 short beep sounds, a long beep sound will follow, indicating that the card has become the master card.

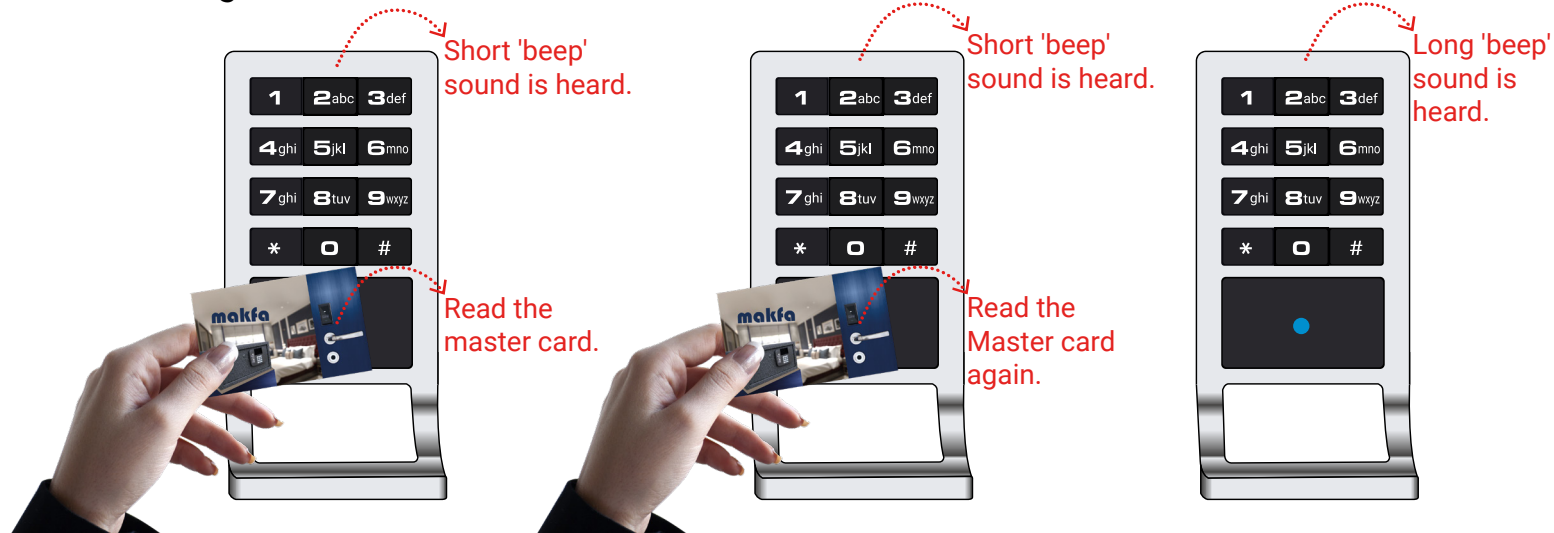

## CREATING USER CARD

- After creating the Master card, read the Master card on the cabinet lock 2 times. While the blue LED is flashing, read the cards you want to create. For each card you read, you will hear a 'beep' sound, indicating that a user card has been created. If you hear the 'beep' sound twice during this process, it means that the user card has been previously created.

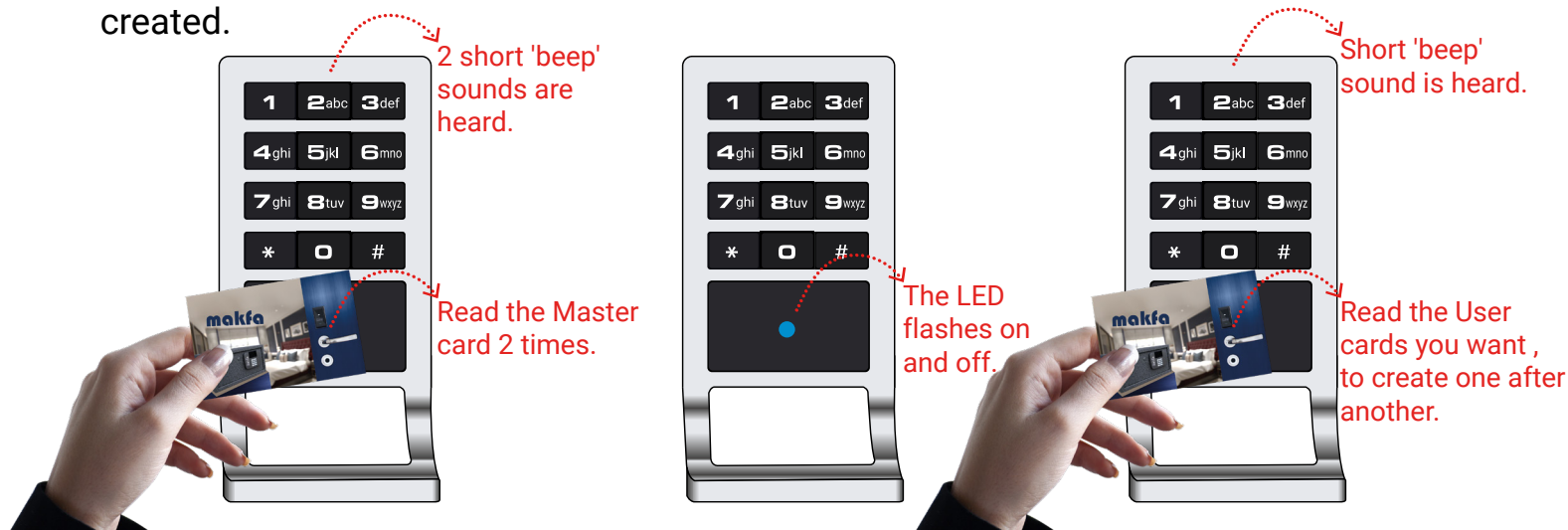

## USER CARD DELETION PROCESS

- To delete the user card: Scan the 'Master' card 5 times in a row. When the blue light flashes rapidly, wait for 3 seconds, and then the blue LED will flash 3 times, indicating that all user cards have been deleted."

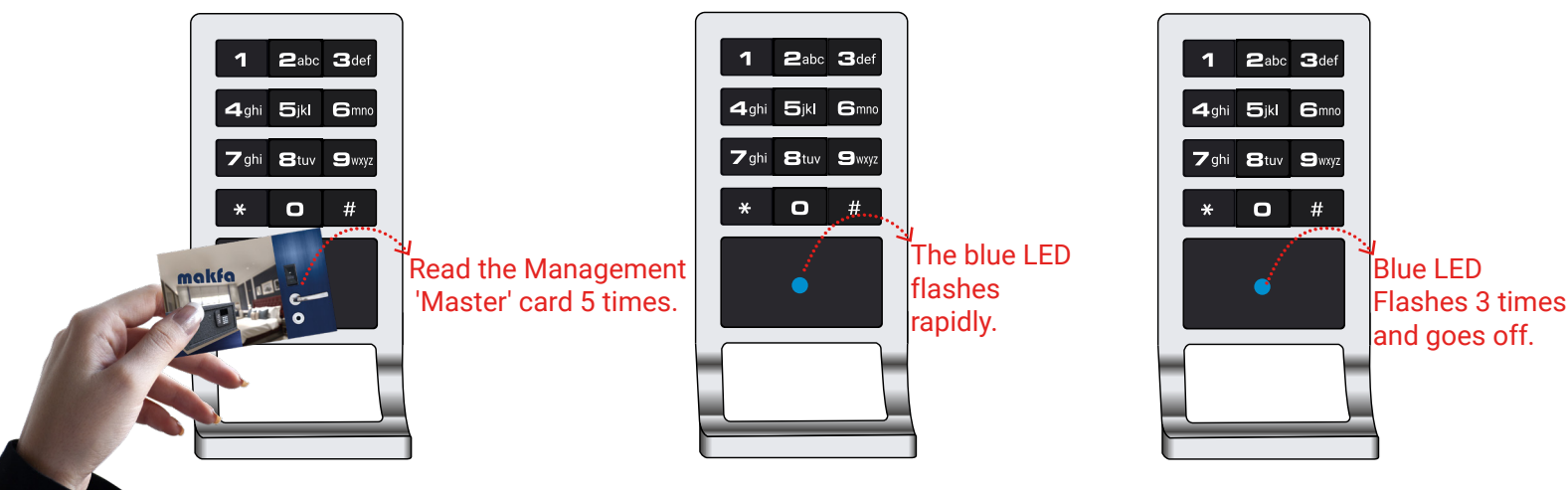

## PROCEDURE FOR DELETING LOST USER CARD

- To delete a lost user card, read the Management 'master' card 4 times in a row while the blue light is flashing rapidly. While the blue light is flashing rapidly, read the user card prior to the lost one on the cabinet lock. For instance, to delete the second lost user card, please read the first user card on the cabinet lock; to delete the fourth lost user card, read your third user card on the cabinet lock. To complete the process, read the first user card, and when you hear 2 "beep" sounds, the lost user card has been successfully deleted.

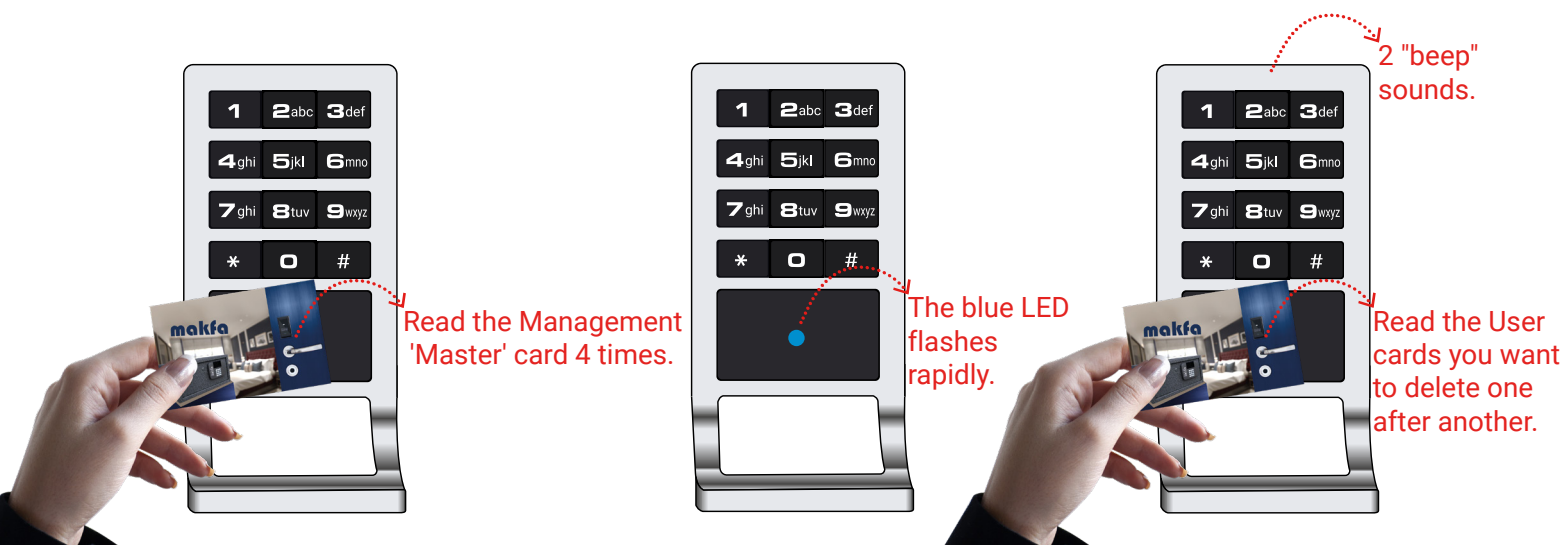

- To delete other lost user cards, you can repeat these steps.

## CHANGING THE MASTER PASSWORD

- The default Master password is "00000000", and the method for changing the Master password is as follows: Hold down the "#" button. The blue LED will flash on and off. Enter the old Master password and press "#" button. Enter the new Master password, which should be 3 to 10 digits, and confirm by pressing "#" button. The blue LED will flash twice, and you'll hear two beeps ("di, di"). This indicates that the Master password has been successfully changed.

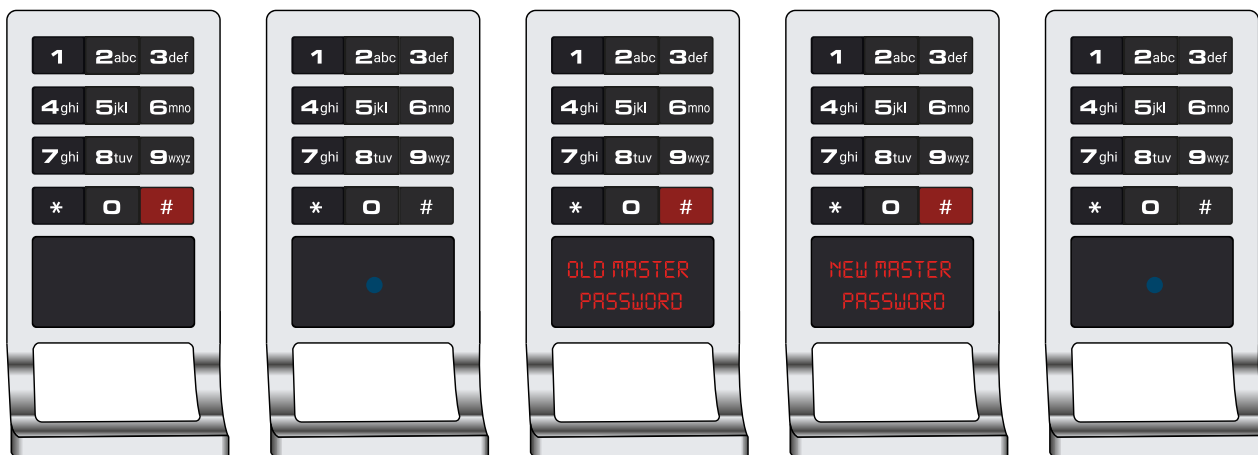

## To OPEN WITH THE 'MASTER' PASSWORD

- Enter your 'Master' Password, then press the '#' button. The blue LED will light up, and you can unlock the cabin lock.

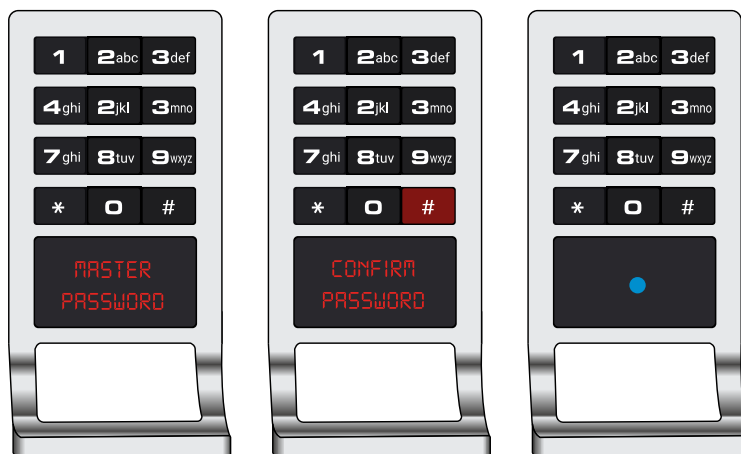

## CABINET LOCK OPERATION MODES

- There are two operating modes: Private and Public mode.
- Private mode: User password and Master password are set, and the lock can only be opened using those passwords. It automatically locks itself. Private mode is preferred for card-based usage.
- Public mode: Only the Master password is set. The user locks the cabinet with their chosen password, and the lock can be opened with that password.

## SWITCHING THE CABINET LOCK TO PRIVATE MODE

- If the Master password hasn't been changed, it is '00000000'.
- To switch the cabinet lock to Private mode, press "\* # 5# " buttons. The blue LED will flash on and off. A long 'beep' sound will be heard. Enter the Master password. Press "#" button. The blue LED will flash twice, and you'll hear two beeps ("di, di"). This indicates that the lock has switched to Private mode.

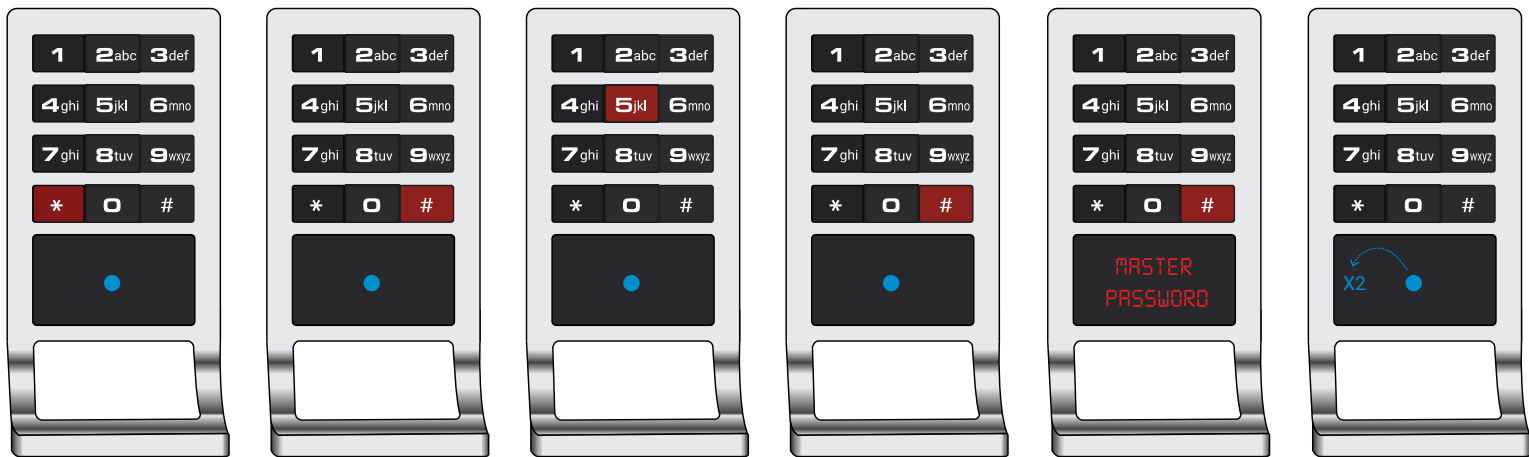

## CHANGING PRIVATE MODE USER PASSWORD

- In Private mode, the default user code is "1111".
- To change the user code in Private mode, press "\* # 6# " buttons. You will hear a 'beep' sound. The blue LED will flash on and off. Enter the current Private mode user password and press "#" button. Then enter the new Private mode user password, which should be 3 to 10 digits, and confirm by pressing "#" button. The blue LED will flash twice, and you'll hear two beeps ("di, di"). This indicates that the Private mode user code has been successfully changed.

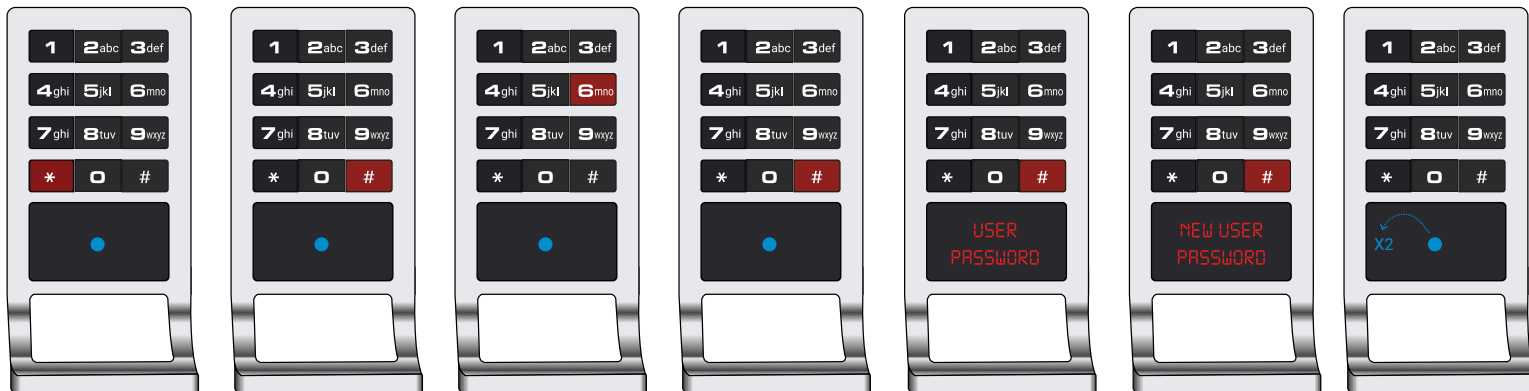

## OPENING AND LOCKING THE LOCK WITH PRIVATE MODE USER PASSWORD

- The Private mode user password is '1111'.
- To unlock the cabinet lock using the Private mode user password, enter the user password and press the "#" button. The blue LED will remain lit for a while. You can now open the cabinet lock. After the blue LED goes off, the cabinet lock will automatically re-lock. You can close and lock the cabinet.

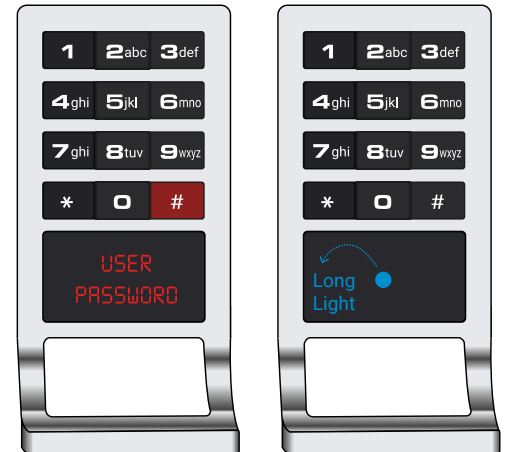

## RESETTING PRIVATE MODE USER PASSWORD TO FACTORY SETTINGS

- If the Master password hasn't been changed, it is '00000000'.
- To reset the Private mode user password on the cabinet lock, press "\* # 1 #" buttons. The blue LED will flash on and off. A long 'beep' sound will be heard. Enter the Master password. Press "#" button. The blue LED will flash twice, and you'll hear two beeps ("di, di"). This indicates that the Private mode user password has been reset to factory settings.

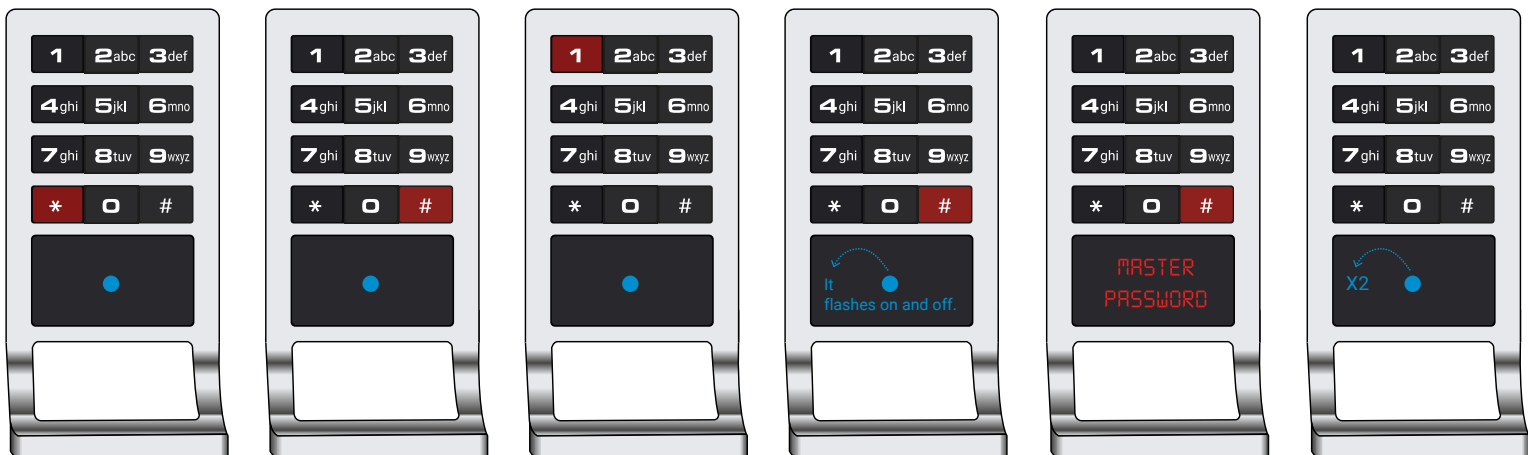



## SWITCHING THE CABINET LOCK TO PUBLIC MODE

- If the Master password hasn't been changed, it is '00000000'.
- To switch the cabinet lock to Public mode, press "\* # 4#" buttons. The blue LED will flash on and off. A long 'beep' sound will be heard. Enter the Master password. Press "#" button. The blue LED will flash twice, and you'll hear two beeps ("di, di"). This indicates that the lock has switched to Public mode.

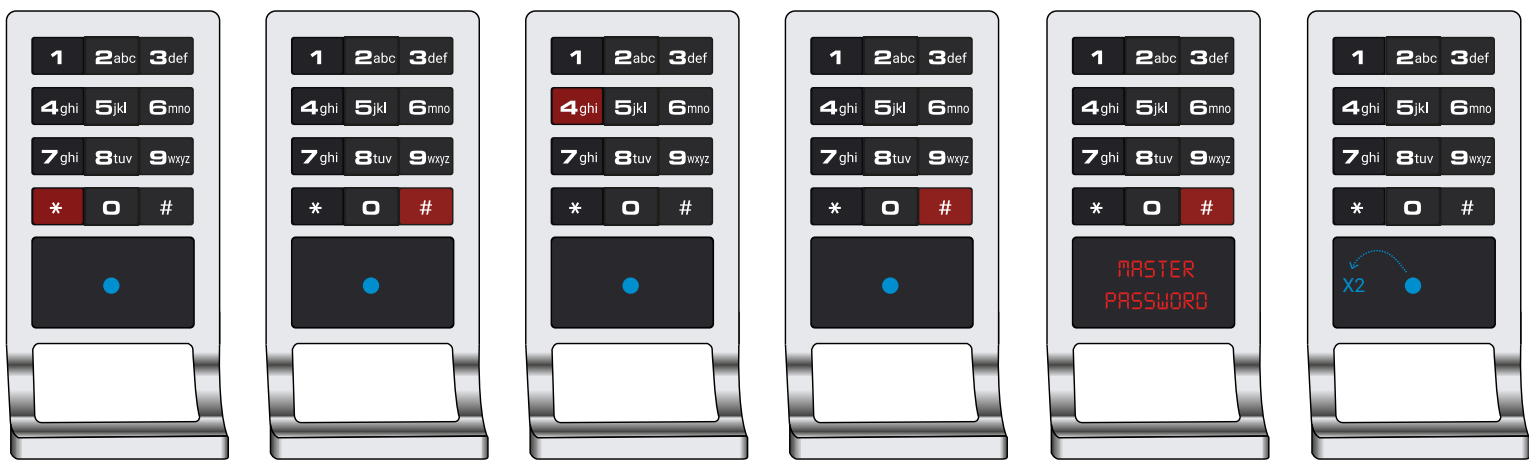

## OPENING AND LOCKING THE LOCK WITH PUBLIC MODE USER PASSWORD

- To lock the cabinet using the Public mode user password, enter the desired user password, which should be 3 to 10 digits, and press the "#" button. Your cabinet lock will be locked.
- To unlock the cabinet using the Public mode user password, enter the previously set user password, which should be 3 to 10 digits, and press the "#" button. Your cabinet lock will open.

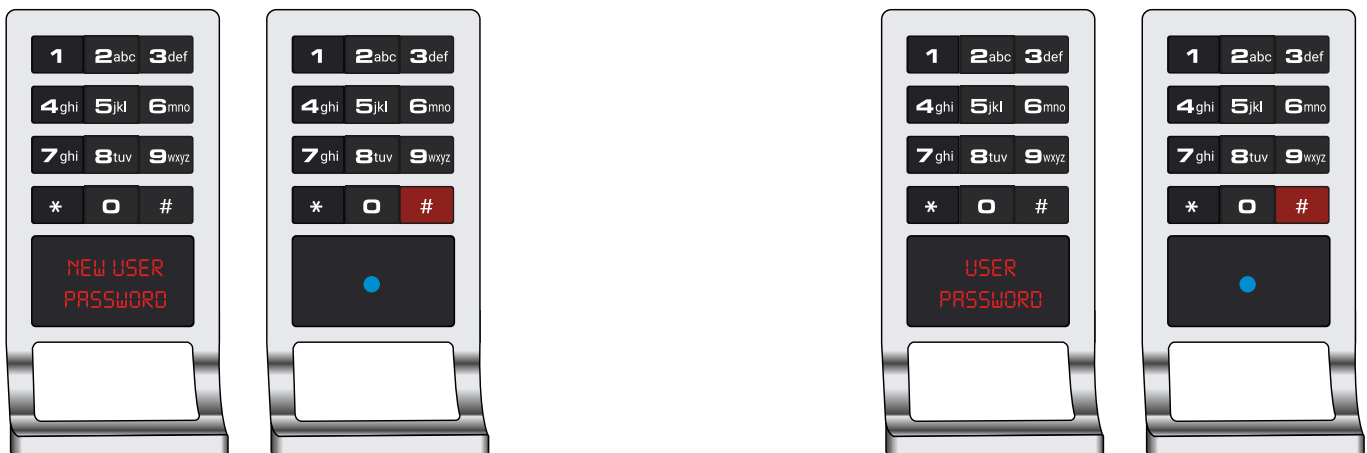



## OTHER FEATURES

- **Warning Sound Feature**  
Provides information about the status by emitting different sounds.
- **LED Warning Feature**  
There are 3 different LED warning colors.  
Yellow and Red LED indicate low voltage, Blue LED indicates that the lock is open.
- **What to Do if Your Cabinet Lock Doesn't Open**
  1. If the battery isn't strong enough to operate the motor, users can connect an external power source (battery box) to provide power to open the lock.
  2. If users forget the password, they can open the lock by entering the master password.
  3. If the mechanism is faulty, the panel can be removed to put the lock in an open state.
- **When the power is very low, enter the password to open the lock, the red LED will flash and an alarm will sound. After the alarm, you can open the lock approximately 100 times.**
- **Password Length:**  
The user password and master password support 3 to 10 digits.
- **Anti-Theft Warning**  
When an incorrect password is entered, the Red LED flashes 4 times and the alarm beeps 4 times. If an incorrect password is entered 3 times in a row, the Password Lock function will activate. Users won't receive any response if any button is pressed for the next 5 minutes. This function is used to prevent the password from being stolen by someone else.